

MAIN LINE

COLUMBUS
TO

XENIA

5259'

53 SCIOTO KITCHEN SALES INC.
54

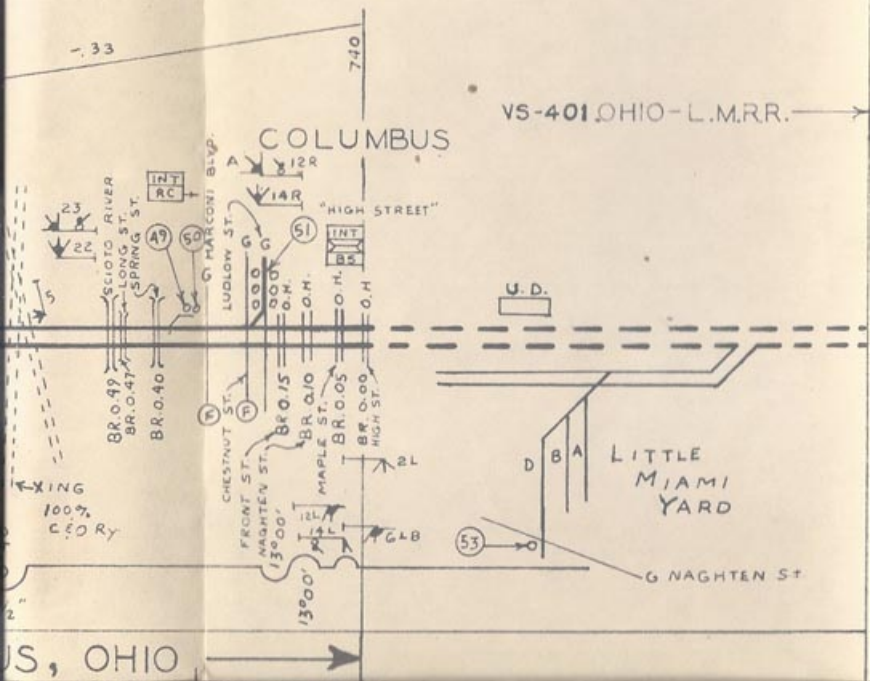

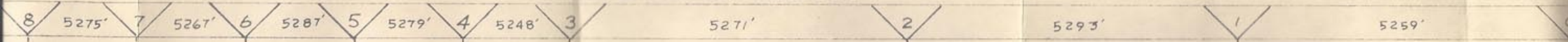

- 0 TEXAS CO.
- 1 SHELL OIL CO.
- 2 A. COLUMBUS TERMINAL WHSE.
- 3 WESTINGHOUSE
- 4 COLUMBUS STATE HOSPITAL
- 5 HARRY WELLNITZ CO.
- 6 COLS. HEATING & VENTILATION CO.
- 7 PULLING FOUNDRY
- 8 H.H. GIESEY BROS. CO.
- 9 CANNON LUMBERTIE & TIMBER CO.

- 49 COLS. & S. OHIO ELECTRIC CO.
- 50 COLS. BOLTS FORGING CO
- 51 NORTH LUDLOW STREET TRACK
- A.
- B. CAPITAL WHOLESALE DRUGS
- C. WM. CALLIF
- D. DEAN & BARRY CO.
- E. EDWARDS TRANSFER & STORAGE CO.
- F.

52

53
54

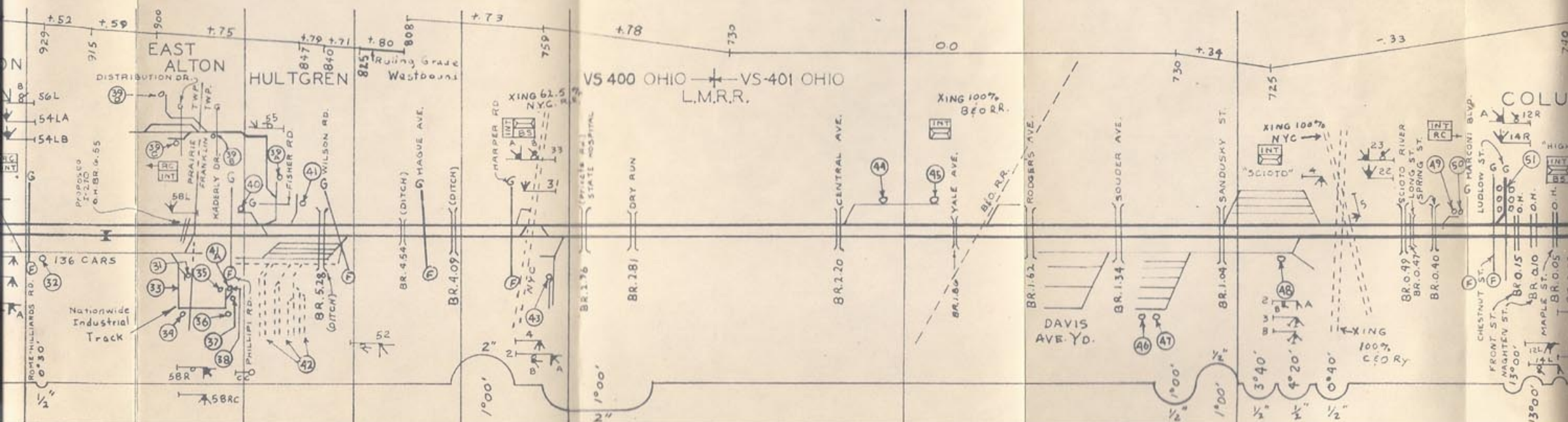

78' 20 5288' 19 5239' 18 5276' 17 5245' 16 5289' 15 5296' 14 5567' 13 5008' 12 5265' 11 5277' 10 5275' 9 5279' 8 5275' 7 5267'

29 OHIO SEED Co.
 30 MURRAY LUMBER & GRAIN Co.
 31 EDITH E. JONES
 32 C.G. REIBEL COAL FEED & LUMBER SUP.
 33 NATION WIDE LEAD TRACK
 34 SURFACE COMBUSTION CORP.
 35 MERCK, INC.
 36 OLIVER FARM
 37 REXALL DRUG Co.
 38 CONSOLIDATED FOODS INC.

39 FISHER ROAD INDUSTRIAL PARK
 39-A. PHILLIPS PETROLEUM Co.
 39-B. E.Z.FLO.
 39-C. LIMA TRUCKING Co.
 39-D. OVERMYER WAREHOUSE

40 TEXAS Co.
 41 SHELL OIL Co.
 41-A. COLUMBUS TERMINAL WHS
 42 WESTINGHOUSE
 43 COLUMBUS STATE HOSPI
 44 HARRY WELLNITZ Co.
 45 COLS. HEATING & VENTILA
 46 PULLING FOUNDRY
 47 H.H. GIESEY BROS. Co.
 48 CANNON LUMBER TIE &

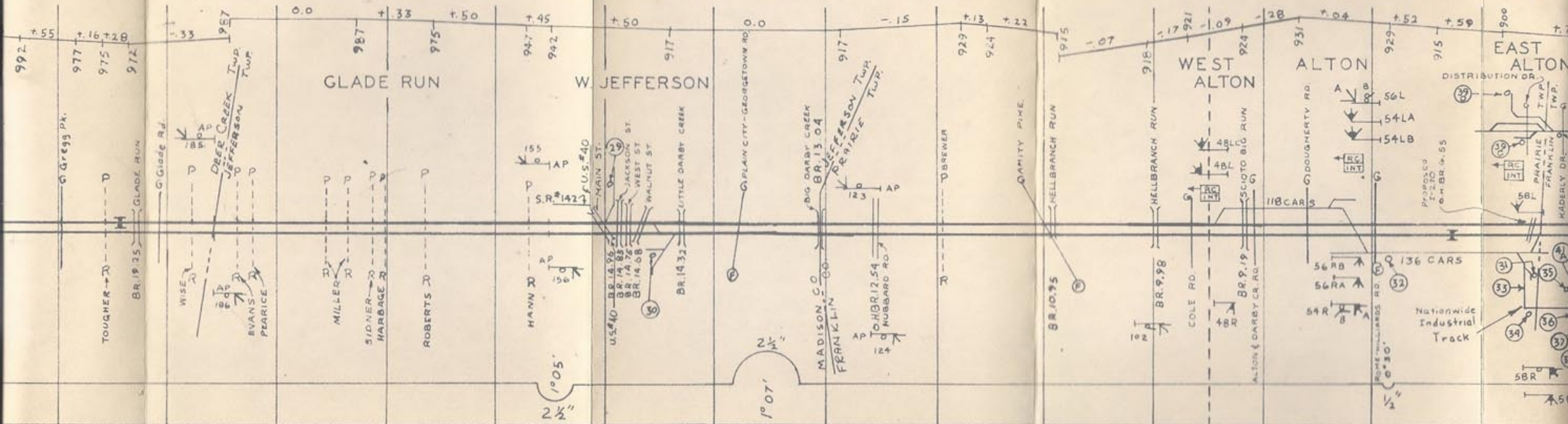

SUB DIVISION No. 4

SUB DIVI

ATCHES...
 5275' 32 5269' 31 5281' 30 5273' 29 5275' 28 5246' 27 5265' 26 5295' 25 5268' 24 5178' 23 5377' 22 5279' 21 5278' 20 5288' 19 5239

- 19
- 20 BRILLO MFG. Co. (Div. of Purex, Ltd.)
- 21 TANNER-ROBISON LUMBER Co.
- 22 E. P. SPEASEMAKER
- 23
- 24
- 25 MADISON FARM BUREAU COOP ASSN.
- 26 McCORD CORP.
- 27 CUSTOM FARM SERVICES, INC.
- 28

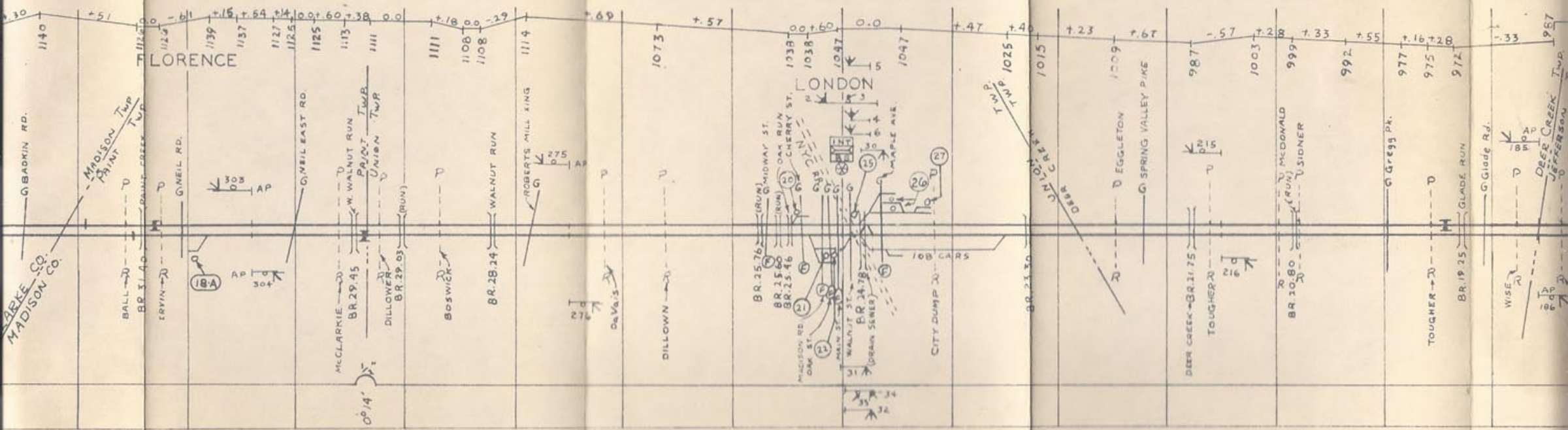

279' 44 5291' 43 5250' 42 5268' 41 5273' 40 5215' 39 5214' 38 5274' 37 5247' 36 5309' 35 5287' 34 5282' 33 5275' 32 5269' 31 528

18-B SWORDS VENEER
18-C MONSANTO CHEMICAL CO.

AL CORP.
U
RP.

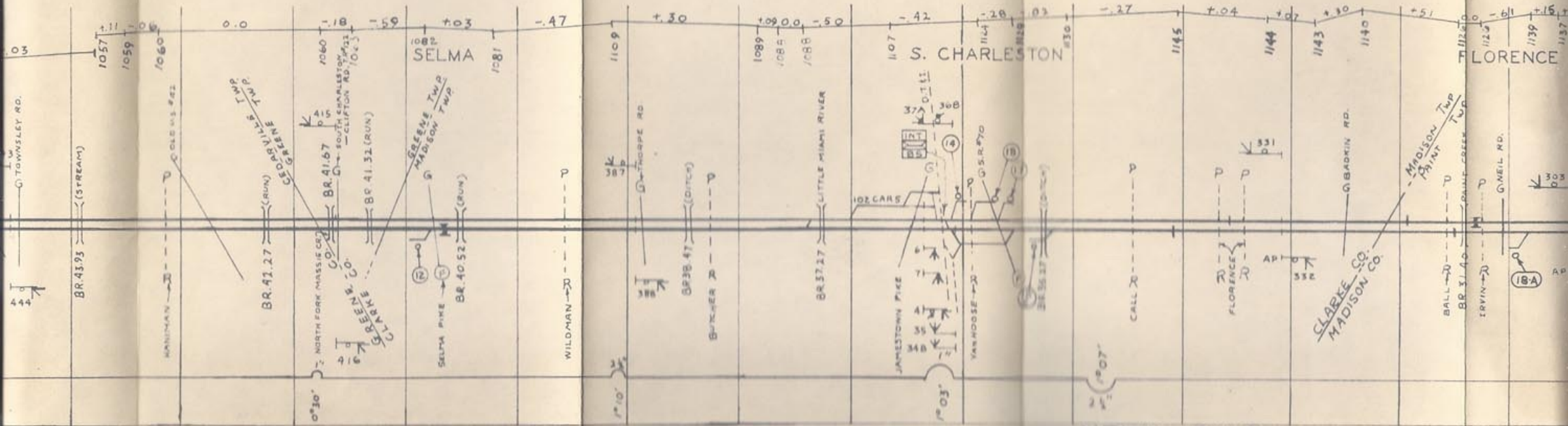

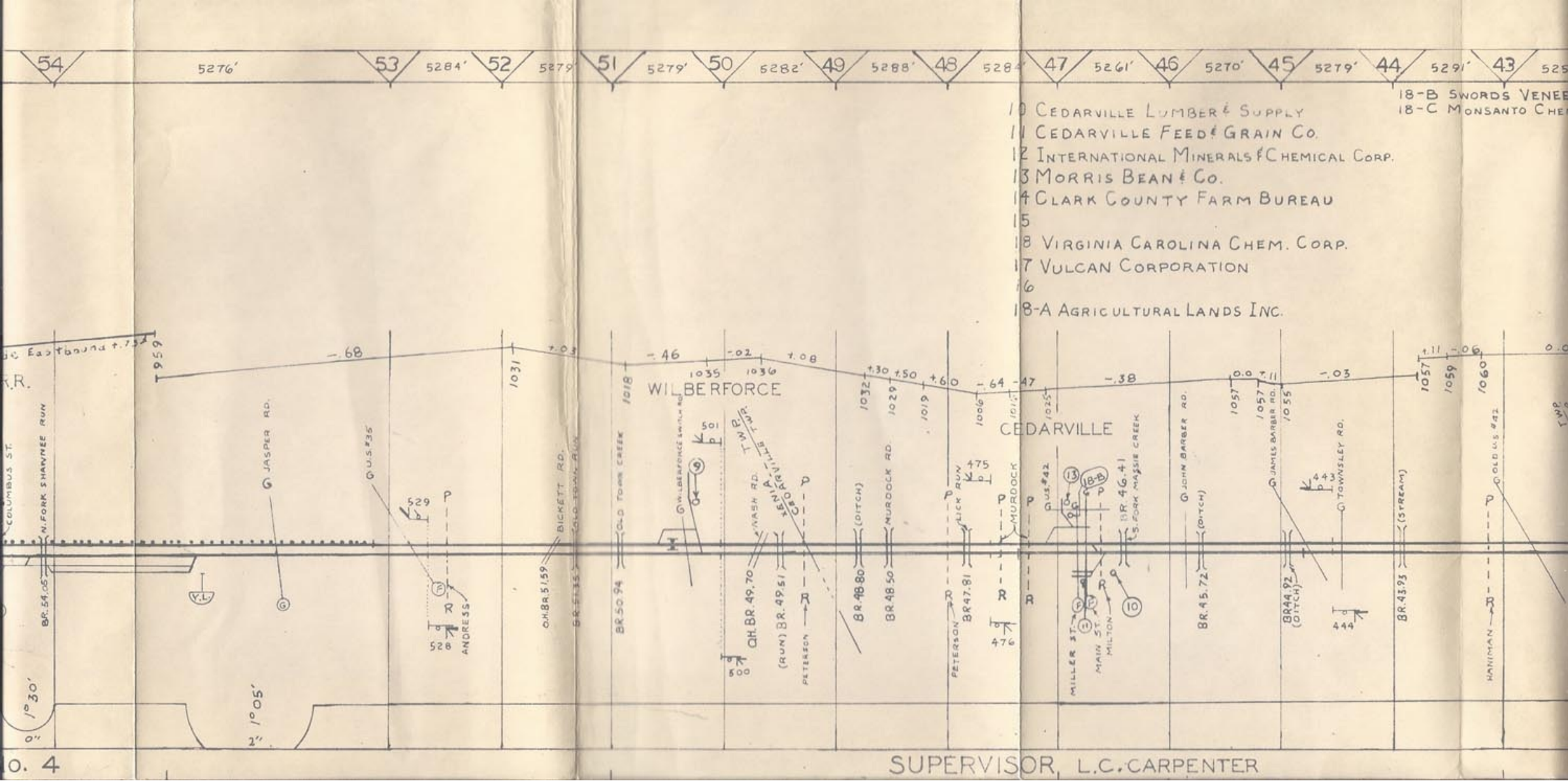

54 5276' 53 5284' 52 5279' 51 5279' 50 5282' 49 5288' 48 5284' 47 5261' 46 5270' 45 5279' 44 5291' 43 5285'

- 10 CEDARVILLE LUMBER & SUPPLY
- 11 CEDARVILLE FEED & GRAIN CO.
- 12 INTERNATIONAL MINERALS & CHEMICAL CORP.
- 13 MORRIS BEAN & CO.
- 14 CLARK COUNTY FARM BUREAU
- 15
- 18 VIRGINIA CAROLINA CHEM. CORP.
- 17 VULCAN CORPORATION
- 16
- 18-A AGRICULTURAL LANDS INC.

18-B SWORDS VENEER
18-C MONSANTO CHEMICAL

WILBERFORCE

CEDARVILLE

56

5284'

55

5277'

54

5276'

- 1 KROHLER MFG. Co.
- 2 POLYMER DISPERSIONS, INC.
- 3 FARM BUREAU COOP ASSN.
- 4 HOOVEN & ALLISON Co.
- 5
- 6 EAVEY Co.
- 7
- 8 OHIO-INDIANA LIVESTOCK BUYERS ASSN.
- 9 CENTRAL STATE COLLEGE

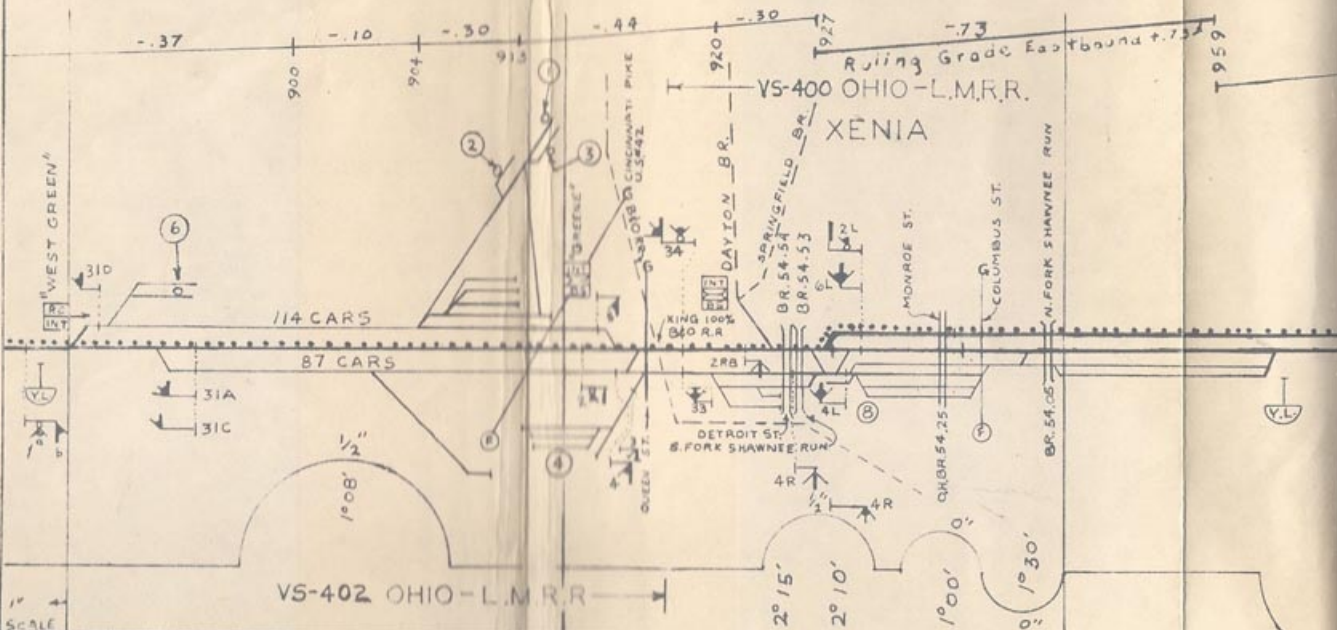

SUB DIVISION No. 4